

St. Bede's Catholic Infant School

Returning to school safely - September 2020

A guide for parents of Reception children



We are looking forward to welcoming our Reception children to our St. Bede's family.



In order to keep everyone safe, we have a new system for arrival and collection from school. The time that your child starts and finishes school will also be different. This is to make sure that all adults can keep as much distance as possible on the playground and on the approach to school.



Each year group will have a different drop-off and pick-up time and each class will have a different entry point onto the playground.

Part-Time

Monday 7th September to

Friday 18th September 2020

Arrival and collection times for

Reception

Siblings only

If you have 2 or more children in the Infant school in different year groups

(e.g. a child in Reception and a child in Year 2)

AM - Arrival is 8:35am Collection is 11:30pm

PM - Arrival is 1:00pm Collection is 3:00pm

Please see following map for route

Map for siblings when part time – AM

Times to be strictly adhered to, in order to maintain harmonious social distancing and continuous flow.

Your child should arrive at school at **8:35am**, with their sibling and will depart at **11:30am**.

On arrival, please use the school gate **3** (allocated for siblings). On departure, please use the school gate allocated for your child's class (see reception class route).

Follow the one-way route as indicated on this plan (see Key). Please ensure you adhere strictly to 2 metres social distancing whilst on the school site.

A member of staff will be waiting to greet your child at the allocated entrance as specified on the plan.

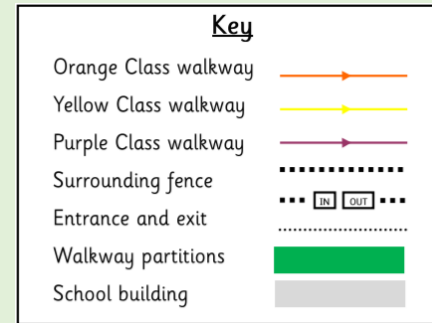

Siblings route:
Arrival at 8:35am

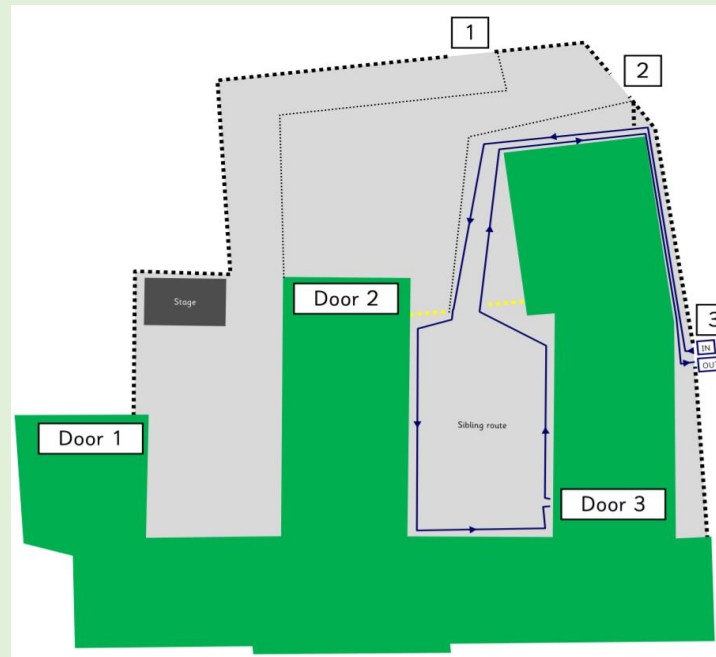

Reception class route:
Departure at 11:30am

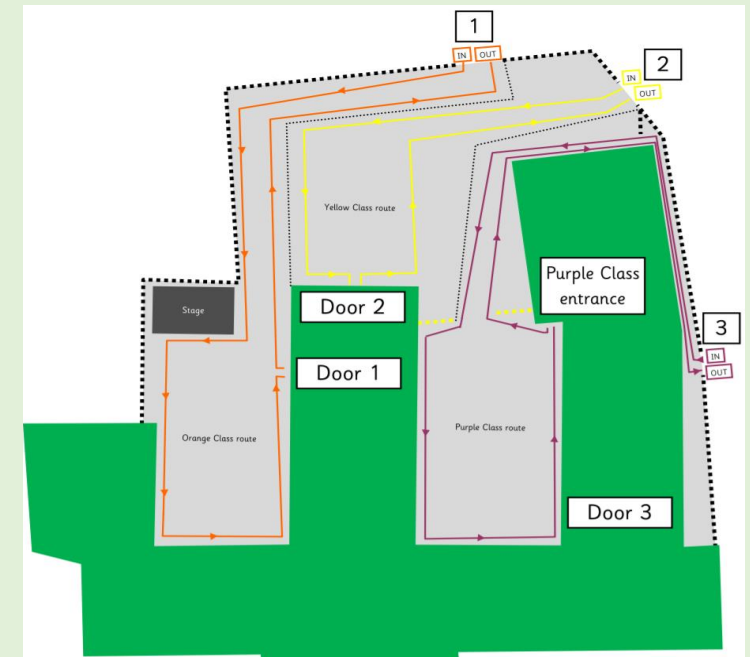

Map for siblings when part time – PM

Times to be strictly adhered to, in order to maintain harmonious social distancing and continuous flow.

Your child should arrive at school at **1:00pm** and will depart at **3:00pm**, with their sibling.

On arrival, please use the school gate allocated for your child's class, (see reception class route). On departure, please use the school gate **3** (allocated for siblings).

Follow the one-way route as indicated on this plan (see Key). Please ensure you adhere strictly to 2 metres social distancing whilst on the school site.

A member of staff will be waiting to greet your child at the allocated entrance as specified on the plan.

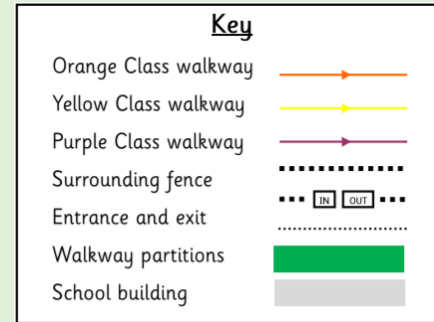

Reception class route:
Arrival at 8:35am

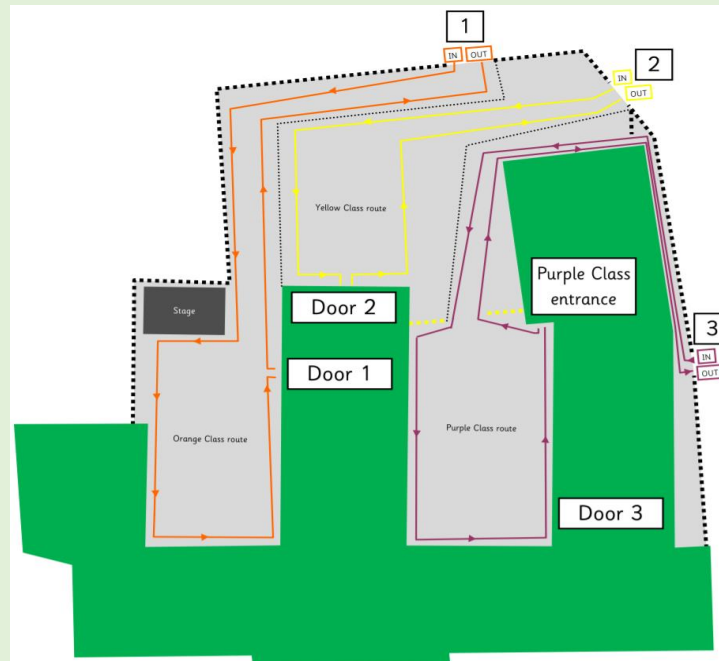

Siblings route:
Departure at 11:30am

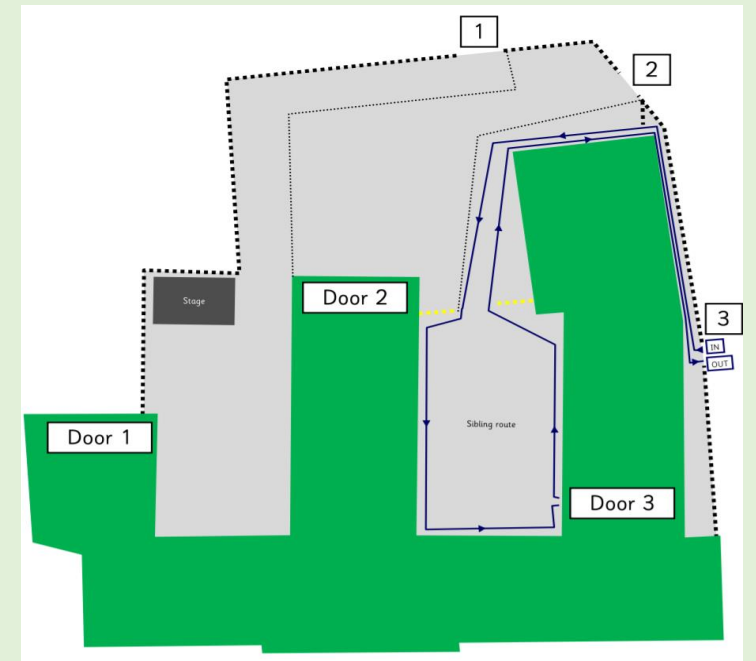

All other Reception Children

AM - Arrival is 9:00am Collection is 11:30pm

PM - Arrival is 1:00pm Collection is 3:25pm

Please see following map for class routes

Map for Reception children when part time - AM

Times to be strictly adhered to, in order to maintain harmonious social distancing and continuous flow.

Your child should arrive at school at **9:00am** and will depart at **11:30am**.

On arrival and departure, please use the school gate allocated for your child's class (see Key).

Follow the one-way route as indicated on this plan (see reception class route). Please ensure you adhere strictly to 2 metres social distancing whilst on the school site.

A member of staff will be waiting to greet your child at the allocated entrance as specified on the plan.

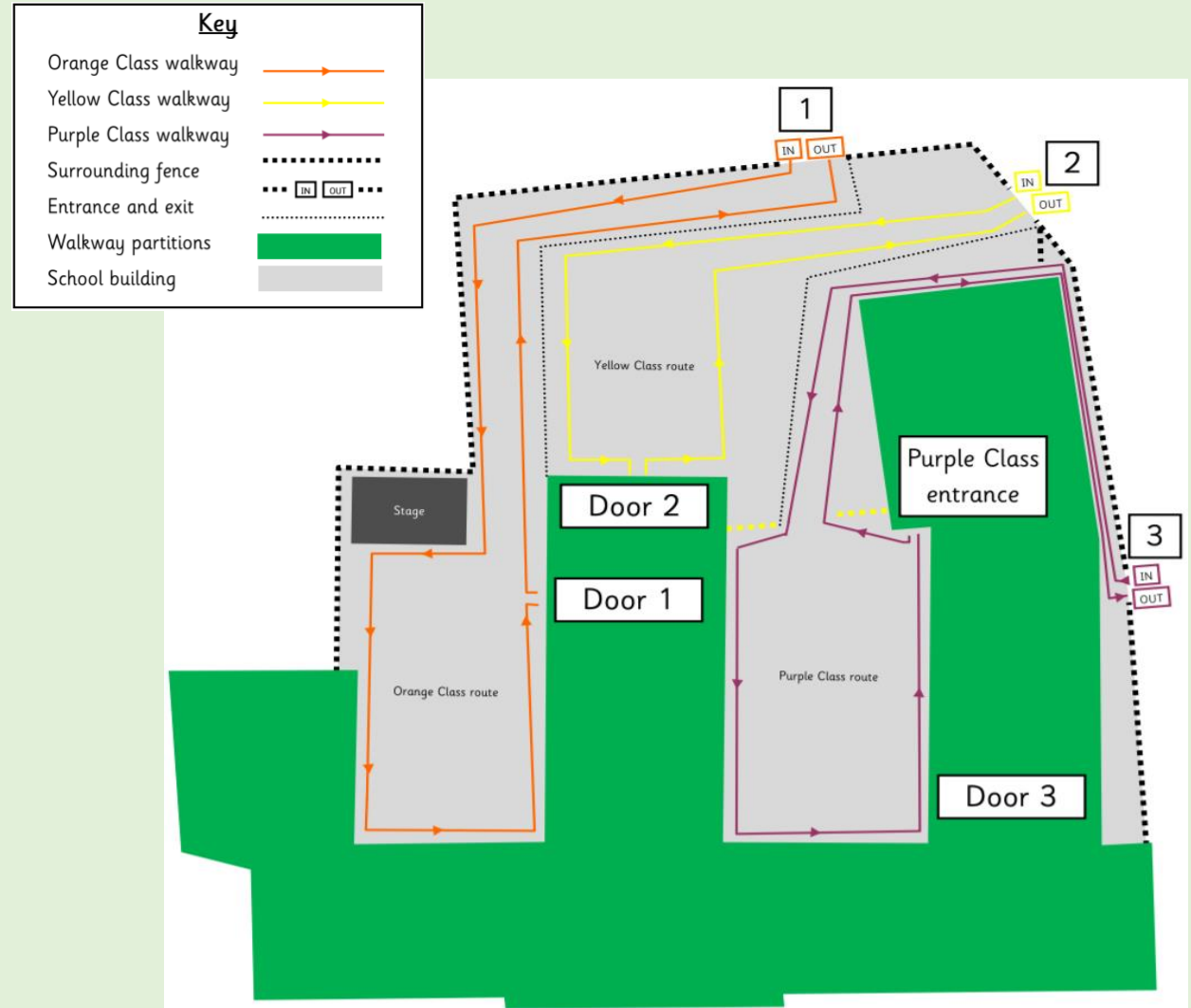

Map for Reception children when part time - PM

Times to be strictly adhered to, in order to maintain harmonious social distancing and continuous flow.

Your child should arrive at school at **1:00pm** and will depart at **3:25pm**.

On arrival and departure, please use the school gate allocated for your child's class (see Key).

Follow the one-way route as indicated on this plan (see reception class route). Please ensure you adhere strictly to 2 metres social distancing whilst on the school site.

A member of staff will be waiting to greet your child at the allocated entrance as specified on the plan.

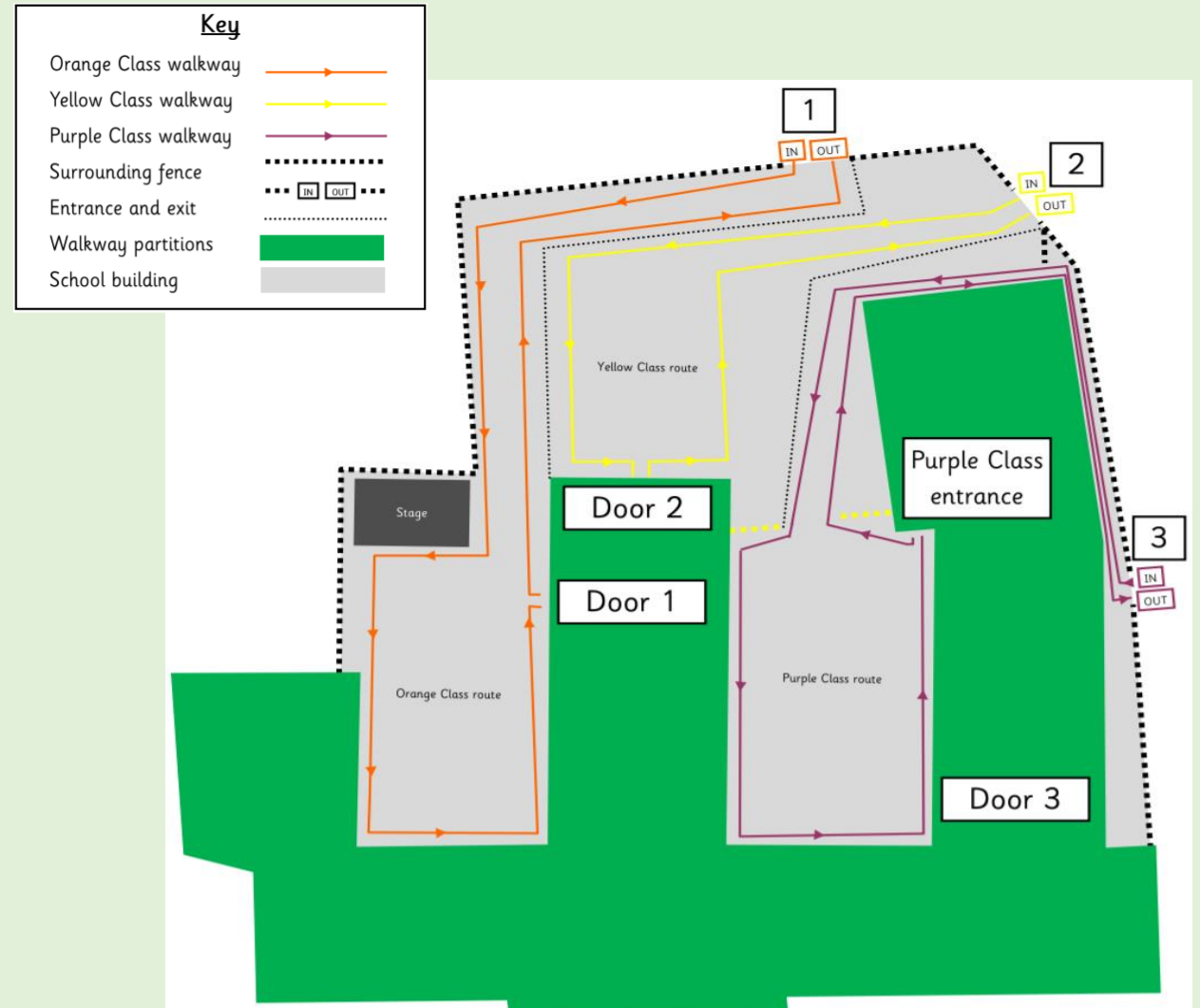

Reception Full time

from 21st September onwards

Siblings only

If you have 2 or more children in the
Infant school in different year groups

(e.g. a child in Reception and a child in Year 2)

Arrival is 8:35am Collection is 3:00pm

Please see following map for route

Sibling entrance and exit plan

Times to be strictly adhered to, in order to maintain harmonious social distancing and continuous flow.

Your children should arrive at school at **8:35am** and will depart at **3:00pm**.

On arrival and departure, please use the school **gate 3**.

Follow the one-way route as indicated on this plan (see Key). Please ensure you adhere strictly to 2 metres social distancing whilst on the school site.

A member of staff will be waiting to greet your children at the allocated entrance as specified on the plan. You will also collect your children from the same door at the end of the day.

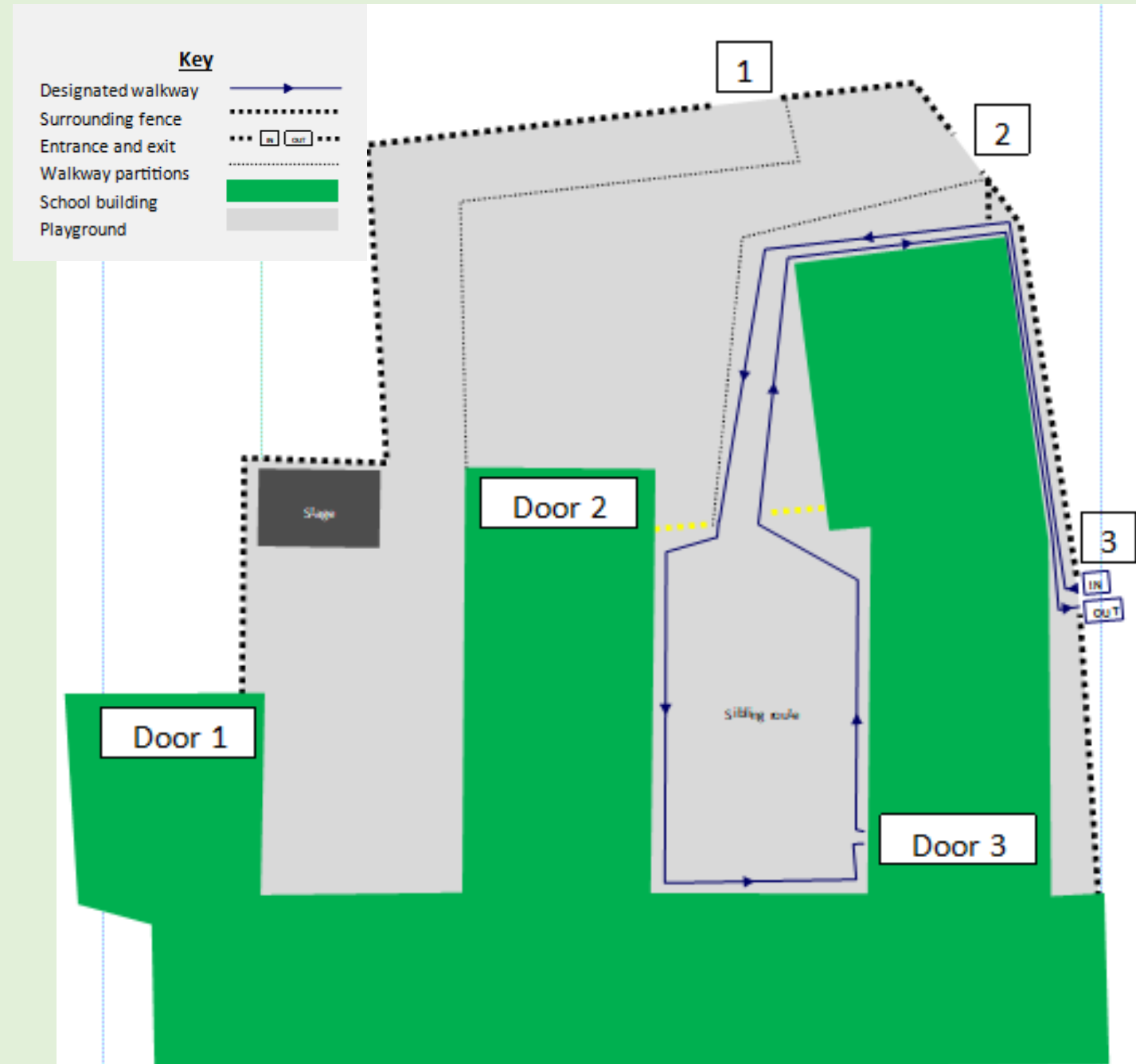

All other Reception Children

Arrival is 9:00am Collection is 3:00pm

Please see following map for class routes

Reception entrance and exit plan

Times to be strictly adhered to, in order to maintain harmonious social distancing and continuous flow.

Your child should arrive at school at **9:00am** and will depart at **3:25pm**.

On arrival and departure, please use the school gate allocated for your child's class.

Follow the one-way route as indicated on this plan (see Key). Please ensure you adhere strictly to 2 metres social distancing whilst on the school site.

A member of staff will be waiting to greet your child at the allocated entrance as specified on the plan. You will also collect your child from the same door at the end of the day.

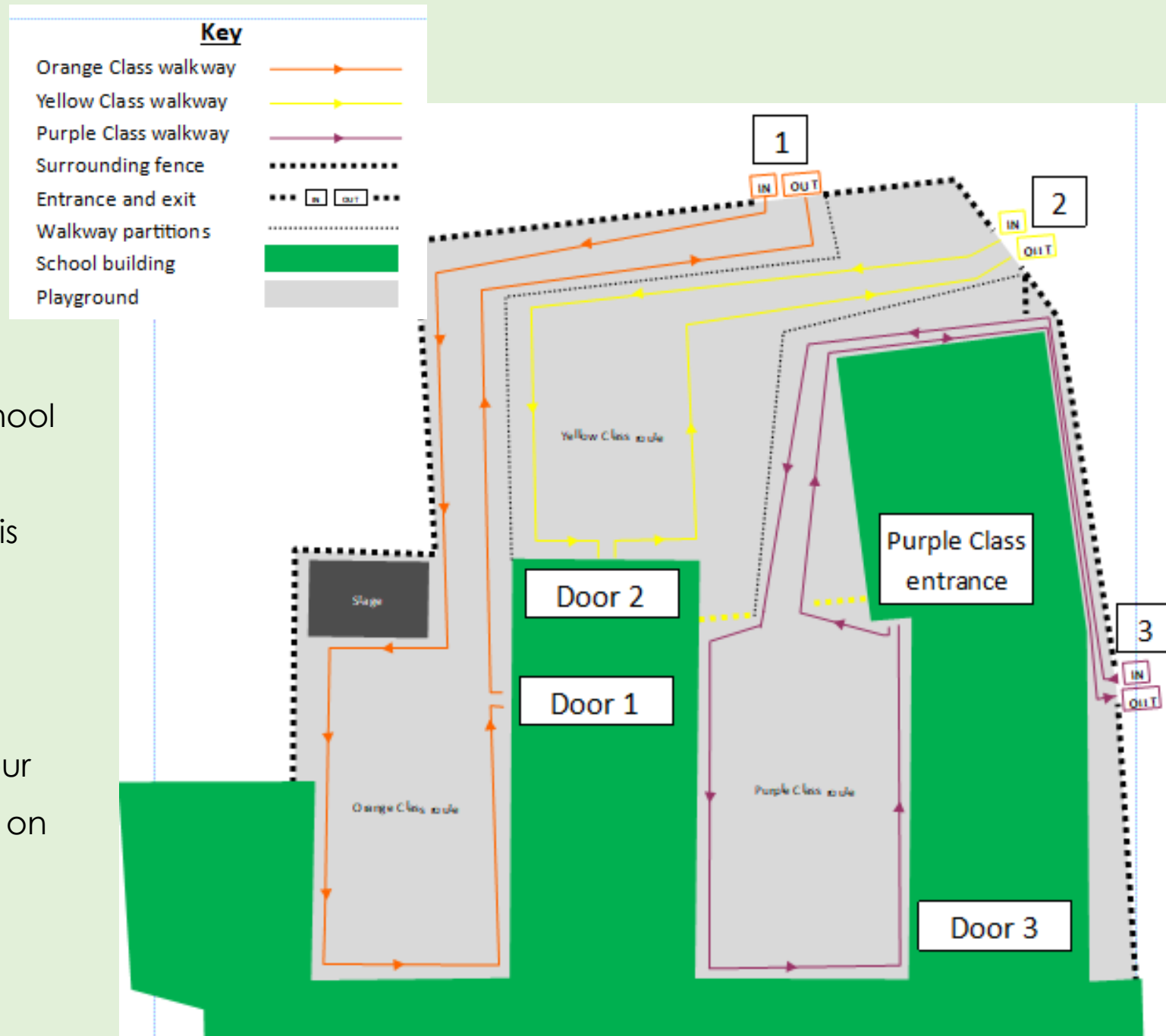

Please do not arrive early or
late to drop off or collect
your child.

If you arrive early, please wait in your car or if on foot, somewhere away from the carpark until just before your child's designated arrival time.

Please remember that all these measures are in place for everyone's safety.

General Information

- Children should wear school uniform
- Children should not bring anything in from home other than:
 - Book bag (No large bags or attachments e.g. key rings/ornaments)
 - reading book/reading diary/home school book
 - Water bottle
 - Packed lunch

Keeping our school Covid-safe

Temporary rules to keep us safe in school will be followed from September.

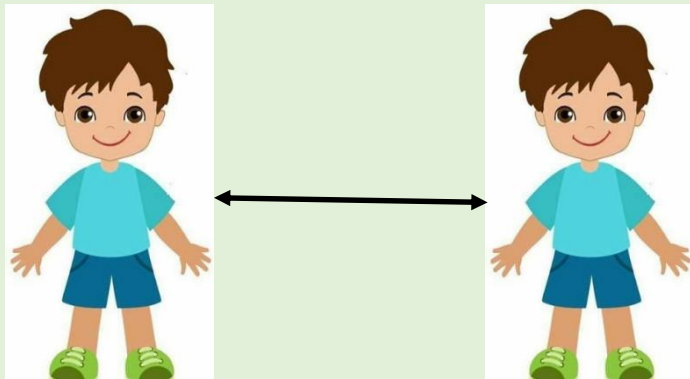

Don't get too close to each other.
Don't touch each other.

Wash your hands regularly, for 20 seconds, using soap and water.



Listen carefully to all of the instructions from the adults.



Keep apart when you are lining up.

Always keep 2 metres apart from the adults.

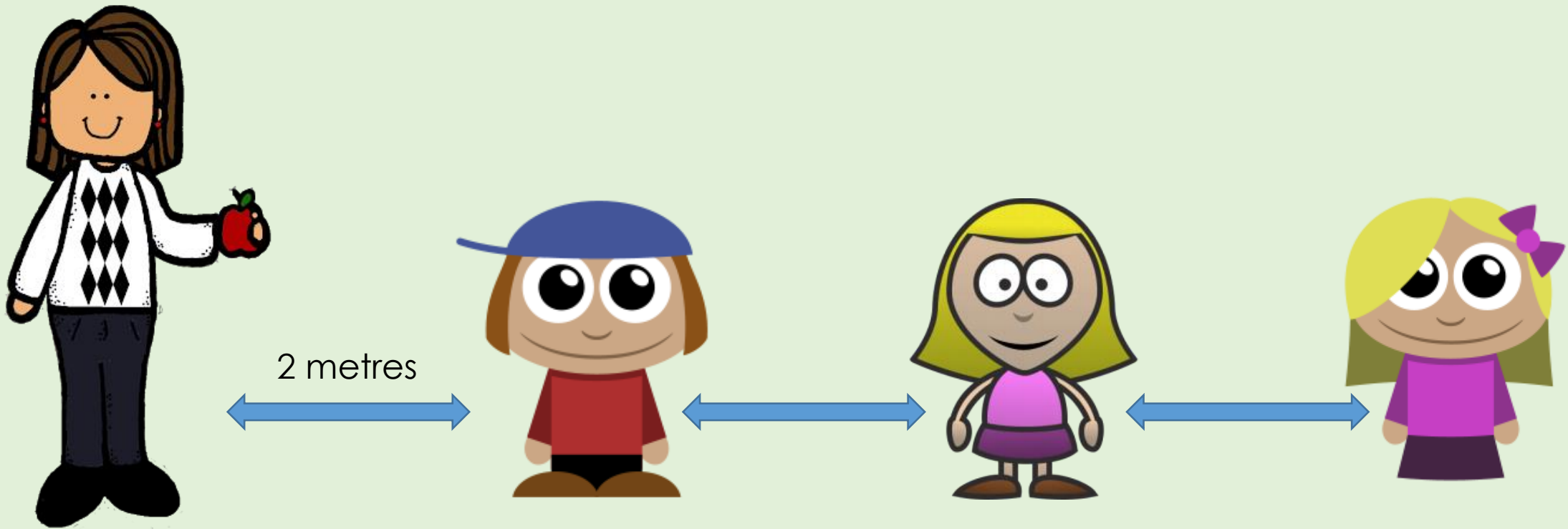

Cover your mouth when you cough or sneeze.

You should try to cough or sneeze into your elbow.

Use a tissue and then put it in one of our 'Catch It, Bin It, Kill It' bins.

CATCH IT

Germs spread easily. Always carry tissues and use them to catch your cough or sneeze.



BIN IT

Germs can live for several hours on tissues. Dispose of your tissue as soon as possible.



KILL IT

Hands can transfer germs to every surface you touch. Clean your hands as soon as you can.



NHS

© Crown Copyright © 2007. 20465544 1p 100% Recycled Paper

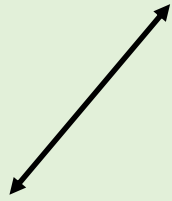
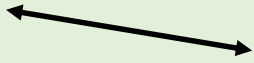

When we are playing try to keep apart and not touch each other.

Keep your things separate from other peoples. Only use your own equipment.



We look forward to seeing
everyone in September

